

EANS2019 Exhibition

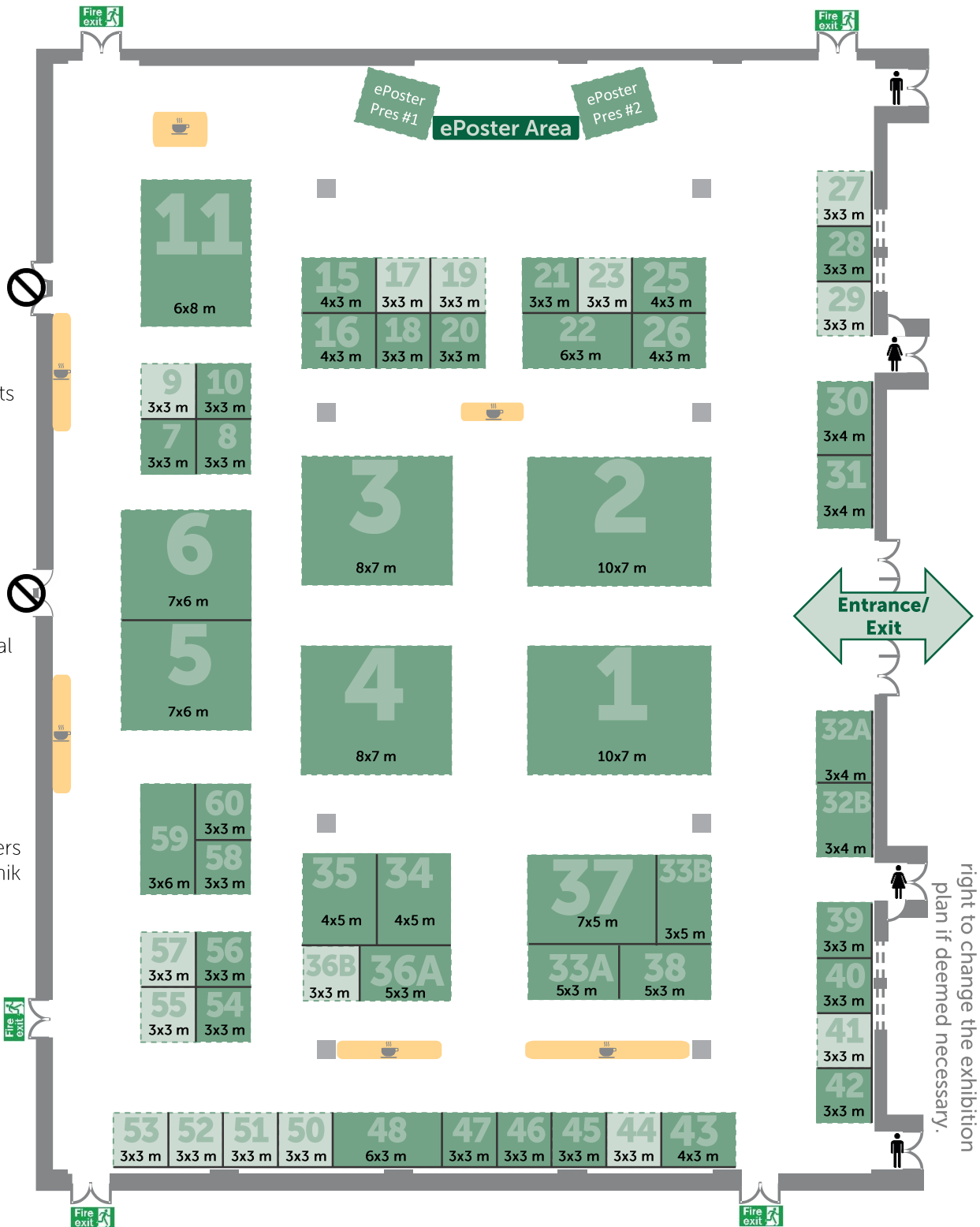

LEVEL 0 – The Forum

- #1 Integra
- #2 Stryker
- #3 B. Braun Aesculap
- #4 Zeiss
- #5 Brainlab
- #6 Medtronic
- #7 Elekta
- #8 OssDsign
- #9
- #10 AD-Tech
- #11 Olympus
- #15 Synaptive Medical
- #16 Karl Storz
- #17
- #18 Bien Air Surgery
- #19
- #20 Tecres
- #21 Charmant Inc
- #22 pro med instruments
- #23
- #25 UFSK International
- #26 Inomed
- #27
- #28 Irras
- #29
- #30 Takayama
- #31 Evonos
- #32A Kontour
- #32B Haag Streit Surgical
- #33A Joimax
- #33B Neurologica
- #34 Accuray
- #35 Magforce
- #36A 3D Side
- #36B
- #37 Zimmer Biomet
- #38 Siemens Healthineers
- #39 Sutter Medizintechnik
- #40 Tissuemed
- #41
- #42 NEOS Surgery
- #43 Medprin
- #44
- #45
- #46 Mectron
- #47 NSK Europe
- #48 Penumbra
- #50
- #51
- #52
- #53
- #54 Spiegelberg
- #55
- #56 Polyganics
- #57
- #58 Söring
- #59 BK Medical
- #60 Peter Lazic



The organizer reserves the right to change the exhibition plan if deemed necessary.

- Solid lines show necessity of a wall of minimum 2.5 meters height.
- Green dashed lines show open sides. Perimeter walling on dashed lines is only allowed to close maximum 1/3 of the open side. Booth walls of more than 1/3 length and 1.5 meters height must have a minimum distance of 1.5 meters back of the booth border.
- Sold exhibition space
- Available exhibition space
- Refreshment area
- Pillar